

Morello Avenue, West Jefferson Avenue & Kachina Street Gallup, New Mexico 87301

4.29 Acre Commercial Zoned Lot

\$2,900,000

Parcel #: R214371



Located in the heart of an extremely active retail shopping area with heavy traffic flow and excellent business exposure.

Direct access to I40.

Valuable street frontage on three sides of the parcel.

Expansion opportunities include: major retail chains, small specialty shops, restaurants, and hotels.

Heavy traffic inflow from surrounding shopping district, Interstate 40, and US Highway 491.

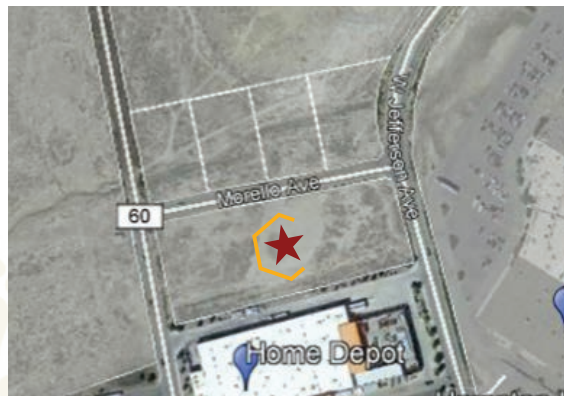

Features include:

This parcel is located in a well-established commercial neighborhood consisting of newer buildings with improvements such as asphalt paved streets, concrete curbs, sidewalks, street lighting, and all municipal utilities. Morello Avenue, W. Jefferson Avenue, and Kachina Street surround the parcel on three of its sides. Traffic from these streets guarantees a steady parade of incoming customers. This parcel may be subdivided.

Please contact us for more information about this and other available properties.

